

DEPARTMENT OF AGRICULTURE

Rural Development

AGENCY: Rural Utilities Service, USDA

ACTION: Notice of Availability of an Environmental Assessment

SUMMARY: Notice is hereby given that the Rural Utilities Service (RUS), as required by the National Environmental Policy Act, is issuing an environmental assessment (EA) in connection with possible impacts related to a project proposed by PowerSouth Energy Cooperative (PowerSouth). The proposal is for construction of a new access bridge to the Charles R. Lowman Energy Center (LEC). PowerSouth has submitted an application to the RUS for funding of the proposal.

SUPPLEMENTARY INFORMATION: PowerSouth proposes to construct a new 960-ft. access bridge that will replace the existing access bridge to the LEC. The location of the proposed project is on PowerSouth-owned property at the end of Carson Road in Leroy, Washington County, Alabama. PowerSouth has prepared an environmental assessment for RUS that describes the project, assesses the proposed project's environmental impacts, and summarizes as applicable any mitigation measures used to minimize environmental effects. RUS has conducted an independent evaluation of the environmental assessment and believes that it accurately assesses the impacts of the proposed project. No significant impacts are expected as a result of the construction of the project.

Written questions and comments should be emailed to RUS at:

RUSPublicComments@usda.gov

RUS will accept questions and comments on the environmental assessment for 14 days from the first date of publication of this notice. Due to COVID-19, no hard copy comments will be accepted. All comments must be provided electronically.

Copies of the Environmental Assessment and supporting documentation will be available for public review at:

<https://www.rd.usda.gov/resources/environmental-studies/assessment/charles-r-lowman-energy-center-bridge-replacement-project>

Any final action by RUS related to the proposed project will be subject to, and contingent upon, compliance with all relevant Federal environmental laws and regulations and completion of environmental review procedures as prescribed by 7 CFR Part 1970, Environmental Policies and Procedures.

A general location map of the project is shown below.

Dated: 03/28/23

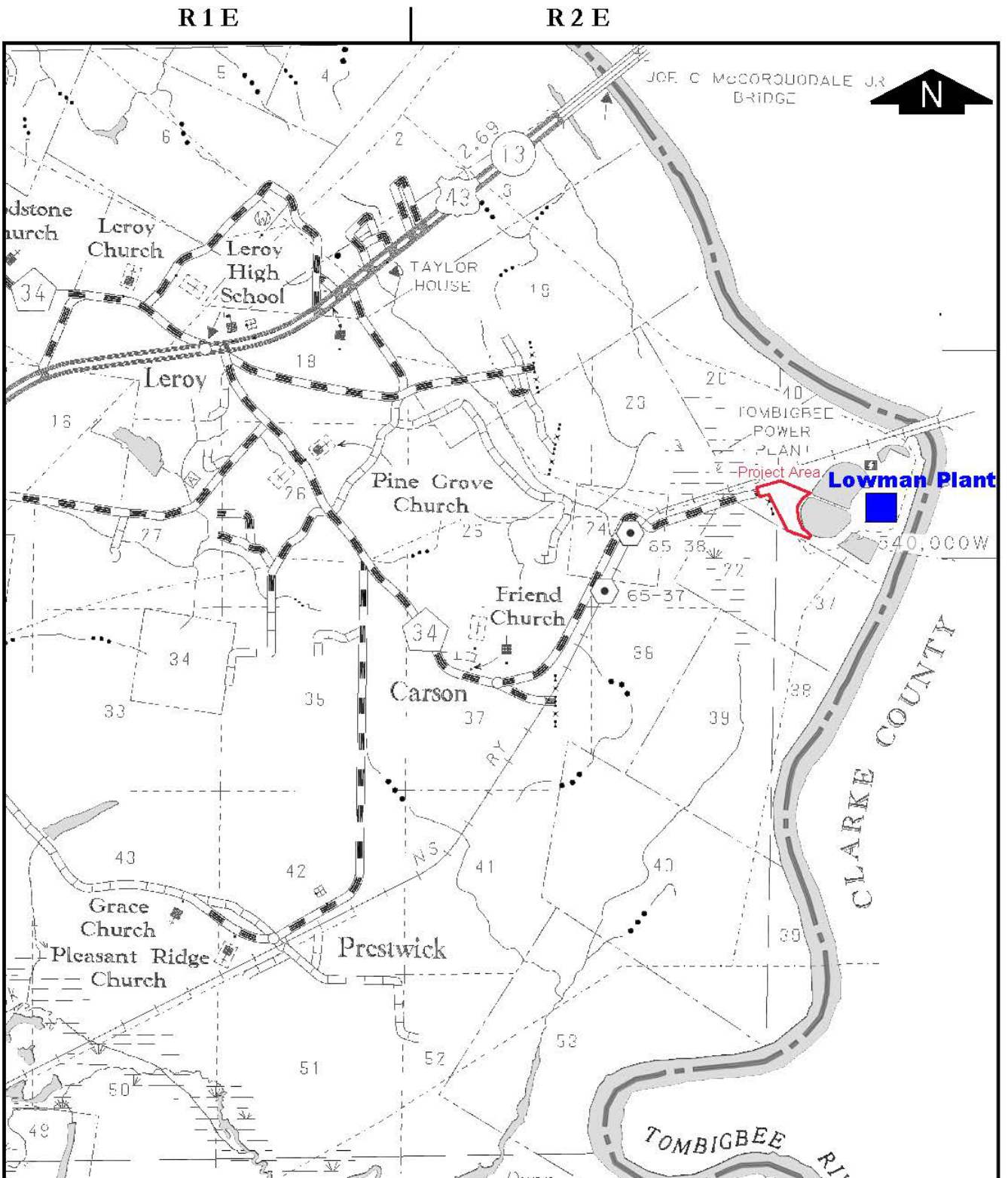

Washington County, Alabama

4392 Carson Road
Leroy, Alabama 36548

Lowman Energy Center Bridge Replacement Project



Drawn: K. Hall

Date: 9/19/2022

c:\data\vicinity\lowmanplnt.dwg